

FLOOR PLAN AND CAPACITY CHART

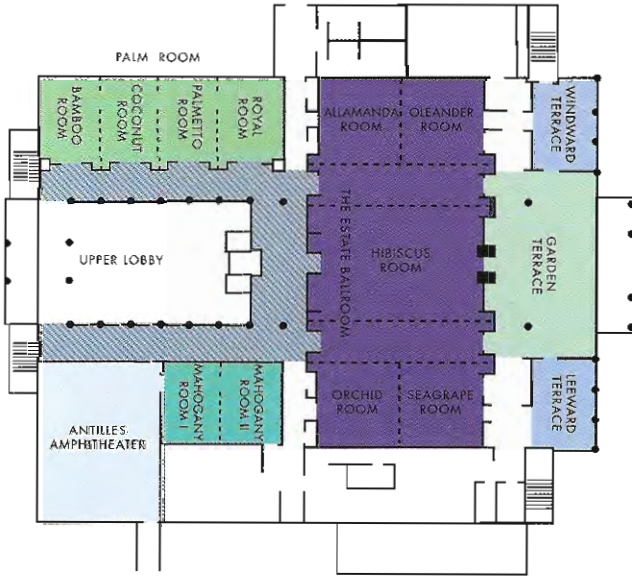

- LARGEST EVENT ROOM 6,720 SQUARE FEET
- LARGEST EVENT ROOM SEATING CAPACITY 800
- NUMBER OF MEETING / EVENT ROOMS 14
- SMALLEST EVENT ROOM 560 SQUARE FEET
- SMALLEST EVENT ROOM SEATING CAPACITY 50
- TOTAL SPACE AVAILABLE FOR EVENTS 17680 SQUARE FEET



ROOM	DIMENSIONS	SQ. FT.	CEILING HT.	RECEPTION	BAH/LIFE	THEATER	CLASSROOM	U-SHAPE
THE ESTATE BALLROOM	56' x 120'	6,720	15'	725	525	745	465	
ALAMANDA	28' x 28'	784	15'	80	60	90	55	25
OLEANDER	28' x 28'	784	15'	80	60	90	55	25
ORCHID	28' x 28'	784	15'	80	60	90	55	25
SEAGRAPE	28' x 28'	784	15'	80	60	90	55	25
HIBISCUS	56' x 38'	2,128	15'	220	170	250	145	
FOYER	open	2,640	12'	260				
GARDEN TERRACE	30' x 60'	1,800	17'	200	150	200		
WINDWARD TERRACE	20' x 31'	620	17'	60				
LEEWARD TERRACE	20' x 31'	620	17'	60				
PALM ROOM	80' x 28'	2,240	12'	280	160	200	100	80
BAMBOO	20' x 28'	560	12'	60	40	50	30	20
COCONUT	20' x 28'	560	12'	60	40	50	30	20
PALMETTO	20' x 28'	560	12'	60	40	50	30	20
ROYAL	20' x 28'	560	12'	60	40	50	30	20
MAHOGANY ROOM	40' x 28'	1,120	12'	120	80	100	65	40
MAHOGANY I OR II	20' x 28'	560	12'	60	40	50	30	20
ANTILLES AMPHITHEATER	40' x 48'	1,920	12'			112		

ST. THOMAS U.S. VIRGIN ISLANDS



WYNDHAM
SUGAR BAY
RESORT & SPA

BEWELL



The Wyndham Sugar Bay Resort and Spa is situated hillside at the northeastern end of St. Thomas in the US. Virgin Islands. Set amidst 31 lush tropical acres, this St. Thomas resort overlooks the emerald and blue waters of Water Bay to the north and St. John and the British Virgin Islands to the east where the Atlantic Ocean and Caribbean Sea meet to create Pillsbury Sound. Conveniently located, this St. Thomas resort is just two miles from Red Hook, eight miles from downtown Charlotte Amalie, and six miles from Blackbeard's Castle and Paradise Point.

From sun worshipping and shopping to sailing, snorkeling and scuba diving, the Wyndham Sugar Bay Resort and Spa and St. Thomas are filled with opportunities to explore unlike any other Caribbean island - and as part of the U.S. Virgin Islands, access to St. Thomas from the U.S. mainland is easy and quick. **NO PASSPORT IS REQUIRED** - US Citizens travel to the US Virgin Islands by simply bringing a valid photo I.D. and proof of citizenship, such as a birth certificate.



GUESTROOMS

- 294 guestrooms and suites
- 26 ClearAir rooms, featuring PURE technology
- 7 One-bedroom suites
- 1 Governor's Suite

GUESTROOM AMENITIES

- True Blue Spa bath amenities
- Wyndham Be Well Beds
- Electronic in-room safe
- Coffee maker
- Color satellite TV
- Direct-dial telephone
- Iron and ironing boards
- Hairdryer
- Clock radio
- Private balcony

DINING

- MANOR HOUSE serving breakfast and dinner
- MANGROVE RESTAURANT contemporary outdoor poolside bistro with live entertainment nightly
- CARIBE offering a flair of Latin-Caribbean cuisine for dinner
- ERL The Wyndham Café, brewsilly coffee and offers snacks, sandwiches, smoothies, and hand scooped Ben & Jerry's ice cream

BARS & LOUNGES

- MANOR HOUSE LOUNGE offers pre-dinner cocktails and small bites
- TURTLE ROCK SPORTS BAR offers a casual atmosphere, poolside
- THE OCEAN CLUB featuring signature cocktails & small bites menu, dancing, slot machines and video lottery terminals

RECREATION

- Three interconnecting freshwater pools and Jacuzzi
- Tennis complex, with laykoid surface courts - lit for night play, including stadium court
- Winner's Mini Golf Course and Bumper Boats (additional charge)
- Award winning Journey's Spa and Fitness Center
- All day activities program and nightly entertainment
- Video lottery terminals featuring 12 games including bingo, keno blackjack, poker and video roulette.
- Watersports center offers jet skis, kayaks and sunfish sail

